

BRISCO



CAPABILITIES

LASER CUTTING:

MILD STEEL: 1", ALUMINUM: 1/2", STAINLESS: 3/4"

Also: Titanium, Polycarbonate, ABS, HDPE,

ROUND, SQUARE, RECTANGULAR TUBING: Up to 12" Diameter

CNC MACHINING:

120" X 96" x 60" Single Set-up

Unlimited Multiple Set-ups

CNC TURNING:

14" DIAMETER X 30"

CNC PUNCHING:

1/4" THICK

MAX - 30 TONS

MANUAL MACHINING:

168" X 60" X 36"

Unlimited Multiple Set-ups

MANUAL TURNING:

84" DIAMETER X 120"

FABRICATION:

CNC Brakes: 120" / 120 Tons

Mechanical Brakes: 144"/225 Tons

Squaring Shears

MIG / TIG / ARC Welding

QUALITY SERVICE SINCE 1966

Truck Arms

BRI-TA51



Standard Truck Arm

BRI-TA51-RH-
With shock mount and choice of insert*.....Price \$275.00

BRI-TA51-LH-
With shock mount and choice of insert* and TrackBar* mount.....Price \$325.00

4130 Material add \$75.00

*See pgs. 5 and 6 for more details

Truck Arms

HOP-TA51



Hopkins Style Truck Arms

(Length and Angle)

HOP-TA51-RH-

With shock mount and choice of insert*.....Price \$275.00

HOP-TA51-LH-

With shock mount and choice of insert* and TrackBar* mount...Price \$325.00

4130 Material add \$75.00

*See pgs. 5 and 6 for more details

Assorted Truck Arms



BRI-TA51-TRK-LH- 2 1/4" Wide LH	\$325.00
BRI-TA51-TRK-RH- 2 1/4" Wide RH	\$275.00
HOP-TA51-TRK-LH-2 1/4" Wide LH	\$325.00
HOP-TA51-TRK-RH-2 1/4" Wide RH	\$275.00
BRI-SSTA51-LH 15° Speedway	\$325.00
BRI-SSTA51-RH 15° Speedway	\$275.00
BRI-SS8TA51-LH 8° Speedway	\$325.00
BRI-SS8TA51-RH 8° Speedway	\$275.00
BRI-SSTA51-TRK-LH 2 1/4" 15° Speedway-2 1/4" Wide LH	\$325.00
BRI-SSTA51-TRK-RH 2 1/4" 15° Speedway-2 1/4" Wide RH	\$275.00
BRI-SS8TA51-TRK LH 8° Speedway-2 1/4" Wide LH	\$325.00
BRI-SS8TA51-TRK RH 8° Speedway-2 1/4" Wide RH	\$275.00

4130 Material Add \$75.00

*Note: All Speedway Arms come with a BRI-5003 serrated shock mount and a non-welded spring perch.

Truck Arm Accessories



Mono Ball For Truck Arm.....MB-INSERT \$27.50



Large Rubber Bushing.....Moog-K6075 \$27.50



Small Rubber Bushing For Truck Arms.....SB-INSERT \$25.00



Weld on HSG to make your truck arms interchangeable
TA-INT-HSG \$17.50



Light weight mono ball HSG for LCA's and Truck Arms
1.75-MB-HSG \$8.50



Spacers for the MB-Insert.....MB-Spacer \$10.25



SNAP RINGS Large Snap Ring for TA-INT-HSG.....\$2.00
Small Snap Ring for MB-INSERT\$1.00

Truck Arm Accessories



5" Center to center
Track Bar Mount
BRI-62502...\$50.00



Combo Plates for
Truck Arms.
BRI-09003-LH/RH
\$12.95

(Not Pictured)

Raised track bar mnt. 1-1/2" over standard
6" center to center adjustment.

BRI-62503 \$50.00

Lowered Track Bar Mount BRI-62504 \$50.00



Standard Shock Mount.....BRI-50002 \$12.50



Serrated Shock Mounts with Washers, "Use these on Speedways
to get shocks in the right place".....BRI-50003 \$23.75



Eccentric Washer, "for those who like it Simple" available in
2" and 2-1/8" (1/4 steel) BRI-25003 2-1/8" "D" hole \$2.50 (each)
BRI-25004 2-1/8" "O" hole \$2.50 (each)
BRI-25027 2" "O" hole \$2.50 (each)
BRI-25026 2" "D" hole \$2.50 (each)



Eccentric Washers, Available in 1/32" increments: 3/16 steel
BRI-TA-SLG00 0-SLUG, \$2.50 (each)
Other sizes (BRI-TA-SLG01,02,03 thru 16) \$2.50 (each)

Cowls

Cut your fab time significantly with these laser cut cowl blanks.

**COT COWLS**

BRI-COT-COWL-PKG.....\$24.50

BRI-05006-1A Cowl Panel\$15.50

BRI-05006-2A Cowl Door\$5.25

BRI-03017A Ledge\$4.95

BGN COWLS

BRI-BGN-COWL-PKG\$21.50

BRI-05002-1A Cowl Panel\$13.25

BRI-05002-2A Cowl Door\$4.25

BRI-03015A Ledge\$4.75

**TRUCK COWLS**

BRI-TRK-COWL-PKG\$31.50

BRI-05003-1A Cowl Door\$4.95

BRI-05003-2A Cowl Panel\$19.50

BRI-03016A Ledge\$8.50

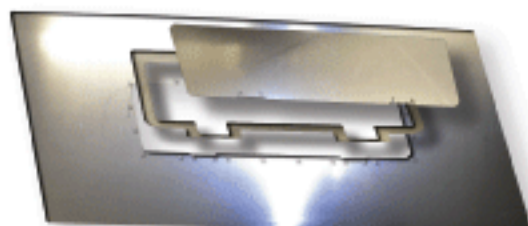

Cup Series

COT WING

BRI-COTWING-PKG \$19.95



COT Wing Mounts available as a pkg or as individual pcs.

Item #1)	BRI-COT-135002	Left or Right	\$5.15
Item #2)	BRI-COT-135003	\$9.35
Item #3)	BRI-COT-135004	\$2.45
Item #4)	BRI-COT-135005	\$1.30
Item #5)	BRI-COT-135006	\$1.00

Speedway Wing Mount

BRI-COT135007.....\$5.50



Cup Series



COT25001A

LUG COVER



Keep your lugnuts safe
from souvenir hunters

Keep glue from
drying too quickly



COT75001

TV Panel Mount Plate for Cars
COT-25001A \$122.55

Made from .040 Aluminum
BRI-LUGCOVER \$5.00

COT Dummy Weight
Bolts onto COT-25001
COT75001 \$32.00



COT-Roll-Bar-Gusset.....BRI-COT-105001 \$9.5



Weld-On-Transponder-MountBRI-COT-135001 \$12.50
(Please specify LH or RH)



Double-Shear-Hood-Tether Pkg.....BRI-DS-TETHER-PKG \$9.25
(Hardware not included)



Weld-Bracket for Data LoggerBRI-DATALOGGER \$17.50



Mounting-Bung for COT TV PanelBRI-COT-BUNG \$2.50



IDR Weld-On-BracketBRI-18733 \$6.75

Miscellaneous Parts



Weld-On Truck Arm Pad, 3/16 steelBRI-18701 \$9.00
(Please specify LH or RH when ordering)



Weld-On 3" Rear GM Brake Bracket,
made from 3/16 steelBRI-18705 \$7.50



Weld-On 3" Front GM Brake Bracket,
made from 3/16 steelBRI-18706 \$7.50



Weld-On-Bracket, goes from sway bar tube to lower
pivot points, made from 3/16 steelBRI-18741 \$27.50



Weld-On-Slotted-Exhaust-Hanger, 1/8 Steel.....BRI-12542 \$3.00



2)Alum-liteweightBRI-SPACE-LW-.060 \$8.25
BRI-SPACE-LW-.125 \$10.50
BRI-SPACE-LW-.187 \$11.50
BRI-SPACE-LW-.250 \$13.75

1)Steel SpacerBRI-SPACE-.060 \$5.00
(counter sunk bolt holes)BRI-SPACE-.125 \$8.75
BRI-SPACE-187 \$9.25
BRI-SPACE-.250 \$11.25

Miscellaneous Parts

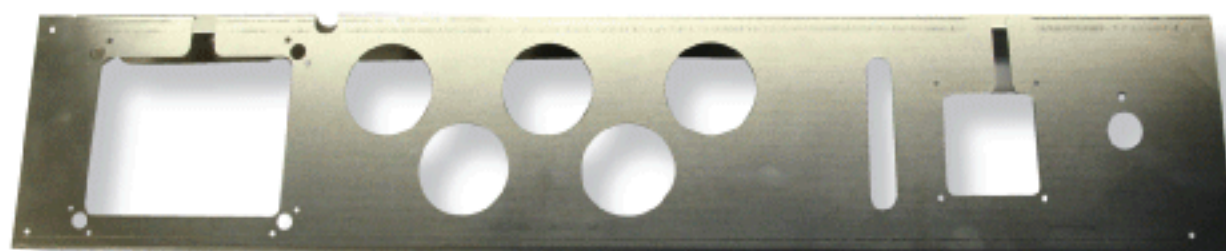

Dash Panel w/5 guages, slot for window, bent channel on top for ignition wires, .050 Aluminum
BRI-05007A \$29.50



Electric Fan Mount for radiator .090 Aluminum. ready to weld or rivet to radiator
BRI-09012 \$7.50



Universal Exhaust Strap w/ 3/8 x 1 1/2 Slots BRI12501 \$14.75



Weld On Deck Lid Prop Mount, Light weight simple idea for supporting deck lid, made from .060 alum.Deck Lid BRI-040701 \$2.25 A) Steel Prop BRI-06022A \$9.50



Hood Prop

light weight and strong
machined 3/16 Alum.
BRI-HOODPROP
\$24.95(each)

Lower Control Arm Slug



1/32 increments

to be used w/BRI-LCA-INS-R
BRI-LCA-Slug-00-16 \$2.00

Rectangular Slugs
Lower Arms



BRI-LCA-INS-R-O \$12.50
BRI-LCA-INS-R-1 \$12.50
BRI-LCA-INS-R-2 \$12.50
BRI-LCA-INS-R-3 \$12.50

Tabs



BRI-WEAR-TAB-ABS
 \$15.00 per 100



BRI-09001 \$.85
 1"x1"x1/4" hole
 .090 Steel



BRI-09002 \$1.50
 2"x1/4"x1-7/8"-1/2" hole
 .090 Steel



Long Seat Belt Tab
 BRI-18711 \$2.00
 2 1/2" tall 3/8" hole



Short Seat Belt Tab
 BRI-18710 \$1.75
 1-3/4" tall 3/8" hole



Hinge Tab
 BRI-09005 \$1.45
 2 1/2" long 3/4" tall
 1/4" hole .090 steel



BRI25025 \$3.00
 2 1/2"x2 1/2"
 Slot 3/8" x 1-3/8"



BRI-12525 \$1.50
 1" center to center



BRI-12526 \$1.75



BRI-06025 \$1.25
 2 1/4" long 1/4" hole
 .060 Steel



BRI-06005 \$1.25
 Weld on Tab for
 Camlocks

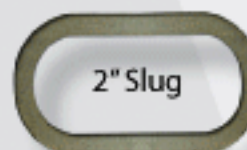

BUMPSHIM
 2" Slug
 .018 \$1.00
 .024 \$1.00
 .030 \$1.00
 .035 \$1.00



BUMPSHIM-2
 1 1/2"
 .018 \$1.00
 .024 \$1.00
 .030 \$1.00
 .035 \$1.00



BRI-06015A \$2.50
 Steering Shaft Pointer
 "Line up steering
 perfect everytime"

Custom Design How-To's

BRISCO

LASER CUTTING

1-877-58-LASER

Custom Parts

Our Special Service For You

Get the parts you want the way you want them.

The following are the quickest ways to get the part you want:

(1-Fastest turn-around.....6-Longest Lead Time)

1. Send a full scale .dxf, .dwg, or .igs flat pattern file as an attachment to an e-mail (parts@briscoinc.com). Make sure to include in the e-mail text what material type and thickness you want. Include also a fully dimensioned drawing if the part is to be formed, welded, machined or otherwise finished after laser cutting.
2. Send a fully dimensioned and detailed 3-view electronic drawing as an e-mail attachment .
3. Send a fully defined solid model as an e-mail attachment. Include in the e-mail text what material you would like.
4. Send a fully dimensioned drawing via Fax (828) 298-8871
5. Send a sharp lined tracing of your part on a 8.5 x 11 white paper via fax. Make reference line somewhere on the page (even if it runs through your part) in order for us to scale the part back to the original size. The fax machine will shrink the tracing between 6% and 12%. Make sure to include what type of material you and thickness you want. Indicate bend lines or secondary operations if necessary.
6. Send a part that you would like duplicated. This could be a poster board or aluminum mock up or your actual part. Make sure to indicate what material type and thickness you would like. We will always do our best to "clean up" any jagged edges of your patterns, but this does take extra time.

Remember!

We won't charge you a layout or set-up fee, but the more work you complete on your end, the less time it will take to get your part on your race car.

Custom Designs



+

+

+

+

Custom Truck Arm Template

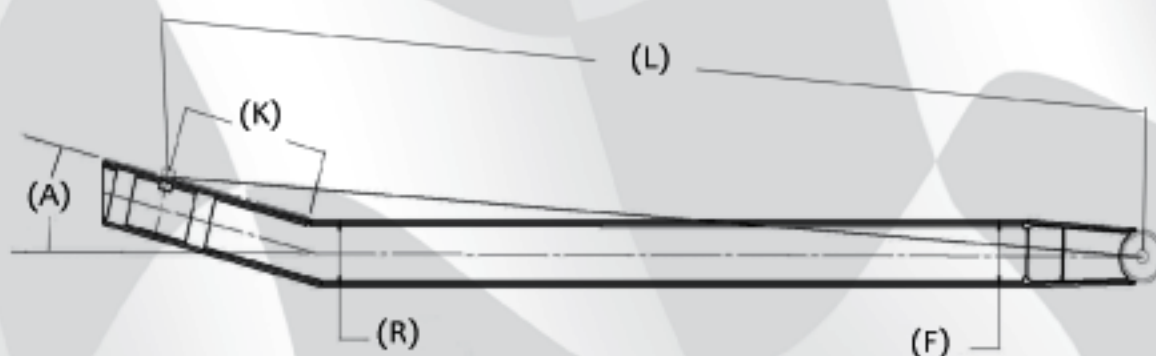

L-Truck Arm Length _____	W-Width _____
(center of bushing to center of pin)	(truck series minimum 2 1/4)
K-Kick up Length _____	WSF-Width Front (stepped beam) _____
(standard: 8-1/8 speedway: 3 1/4)	WSR-Width Rear (stepped beam) _____
A-Kick up Angle _____	T-Thickness _____
F-Front Height _____	Material _____
R-Rear Height _____	(standard: mild steel)

Custom Tab Template

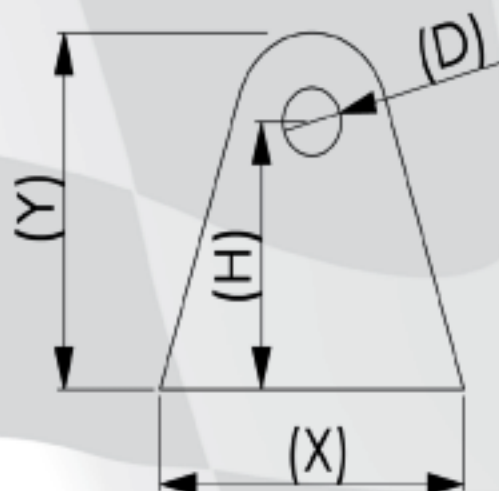

50/50 TAB	X _____
50 Tabs for \$50	Y _____
X & Y - 2" MAX	H _____
T - 3/16 MAX	D _____
	T _____



Brisco Inc is a family owned and operated business with the desire of helping every customer realize their goals and expectations

Since our start in 1966, Brisco has been supporting industry with unparalleled quality and customer service. We strive help our customers to be successful because we know that if our customers succeed then , ultimately we succeed.

One of our goals here at Brisco is to offer you unequalled satisfaction from the time we receive your request for quote, through manufacture and delivery of your equipment or component part. We want to work *with* you, not *for* you.

At Brisco, we are constantly searching for the best manufacturing techniques. This makes us very competitive in price and delivery. Our arsenal of equipment always includes the latest technology in both CNC and conventional machinery and precision measuring instruments.



When you work with Brisco, you work with knowledgeable people with practical shop experience. Our engineering team can help you with questions you may have concerning any aspect of your project including strength of materials and machinery dynamics.

Our design team utilizes parametric solid modeling to help ensure the first attempt of a new or redesigned part is successful.

Brisco can handle any job you have. Our facility allows us to manufacture any part from mere grams to over 125,000 pounds.

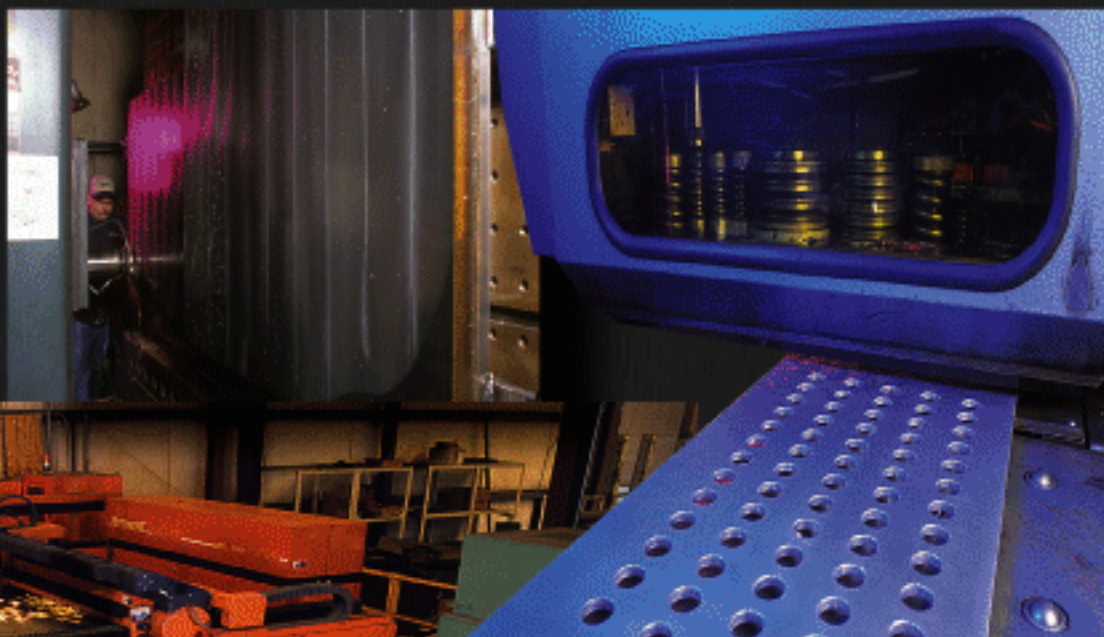

We can complete your project from component part to turn-key machine. When you need parts designed, manufactured or both, call Brisco. 1-800-328-4356

